



UCR HOUSING FOR RETURNING STUDENTS housing.ucr.edu 2021-2022



Be among the first to live at
the all-new NORTH DISTRICT
APARTMENTS SEE PAGE 8



THIS FALL, GET THE MOST BY LIVING AT UCR 24/7!

1 LIVE IN AN ON-CAMPUS APARTMENT

Whether you've spent this year sheltering in place at home, or sheltering in place at one of UCR's Residence Halls, you're probably ready for a change. Heck, a big change.

May we suggest moving into your very own campus apartment community?

In addition to independence, you'll get so much more — like zero commute time, having friends and professors close by, staff on hand 24/7, and business practices flexible enough to handle everything from family emergencies to, well, a worldwide pandemic.

You can even be among the first to move into our newest and most impressive apartment community yet, **NORTH DISTRICT**, which opens its towers this fall.

2 LIVE IN ONE OF OUR RESIDENCE HALLS

Do you feel cheated out of the traditional "Residence Hall Experience" this year? You're not alone. But you're in luck!

Not only are Residence Hall spaces available for returning students like you, you have first crack at the room of your choice. This includes the state-of-the-art **DUNDEE**, which sits adjacent to the dazzling new **GLASGOW RESIDENTIAL RESTAURANT**.

Continuing students like you will be housed in Dundee's upper floors, which is also home to the new **STRIDE 2 SUCCESS** Living-Learning Community, designed to give second-year students extra resources, guidance and programs to aid in their continued growth.

FROM UCR

Want all the advantages
of living on campus?
You've got TWO great options!





Outdoor Lounge at Glen Mor

WHAT DO I DO FIRST...AND

Before you decide: Take a virtual tour

NOW: View our communities from the convenience of your laptop, desktop or smartphone at housing.ucr.edu.

Virtual tours not available for North District Apartments or Dundee Residence Hall, but our website has photos and/or renderings of both.

If you want to move into an on-campus apartment

NOW: Apply year-round at myhousing.ucr.edu. Rooms are filled on a first-come, first-served basis. Current Residence Hall residents (and those who originally signed up to live there) have first dibs at available apartment spaces, including the sure-to-be-in-high-demand North District Apartments!



WHEN DO I NEED TO DO IT?

If you want to stay (or move) into a UCR Residence Hall

MARCH 1-11: Submit a Residence Hall contract during this period (at myhousing.ucr.edu) and get an exclusive opportunity to self-select any room in any Residence Hall. After this date, you'll be competing with incoming freshmen (no doubt anxious to get out of the house) for remaining spaces, and can't be guaranteed a room on the upper floors.

Stonehaven

BLAINE ST

MAP LEGEND

- Residence Hall
- Campus Apartment
- Residential Apartment
- Family Housing

North District

Falkirk

Dundee

WATKINS DRIVE

The Plaza

LINDEN ST.

LINDEN ST.

Housing Administration

Aberdeen-Inverness

Pentland Hills

Oban

Bannockburn Village

Glasgow Residential Restaurant

Glen Mor

Big Springs Parking

UNIVERSITY AVENUE

North Campus Dr.

ABERDEEN DRIVE

Campus Store

Orbach Library

Lothian

BIG SPRINGS RD

60

215

Hinderaker Hall

The HUB

Bell Tower

Rivera Library

Eucalyptus Dr.

International Village

West Campus Dr.

West Campus Dr.

East Campus Dr.

WATKINS DRIVE

UCR HOUSING MAP

CANYON CREST DR

South Campus Dr
College Place

GUIDE TO AMENITIES

- Available/Included
- Available for a fee
- Some Available
- Partial Fee
- Not Available

	Air Conditioning	Heating	Private Bath	Private Kitchen	Furnished	Refrigerator	Dishwasher	Microwave	Stove	TV/Recreation Room	Secure Laundry	Study Lounge	Fitness Center	Computer Lab	Swimming Pool	Recreation Courts/Fields	24-Hour Assistance	Elevators	Social/Educational Prgrms.	On-Site Parking	Utilities Included	Telephone Service	Internet Service	Basic Cable TV Service	Wireless Network
BANNOCKBURN VILLAGE	■	■	■	■	■	■	■	■	■	■	■	■	■	■	■	■	■	■	■	■	■	■	■	■	■
FALKIRK	■	■	■	■	■	■	■	■	■	■	■	■	■	■	■	■	■	■	■	■	■	■	■	■	■
NORTH DISTRICT	■	■	■	■	■	■	■	■	■	■	■	■	■	■	■	■	■	■	■	■	■	■	■	■	■
THE PLAZA	■	■	■	■	■	■	■	■	■	■	■	■	■	■	■	■	■	■	■	■	■	■	■	■	■
STONEHAVEN	■	■	■	■	■	■	■	■	■	■	■	■	■	■	■	■	■	■	■	■	■	■	■	■	■
GLEN MOR	■	■	■	■	■	■	■	■	■	■	■	■	■	■	■	■	■	■	■	■	■	■	■	■	■
ABERDEEN-INVERNESS	■	■	■	■	■	■	■	■	■	■	■	■	■	■	■	■	■	■	■	■	■	■	■	■	■
DUNDEE	■	■	■	■	■	■	■	■	■	■	■	■	■	■	■	■	■	■	■	■	■	■	■	■	■
LOTHIAN	■	■	■	■	■	■	■	■	■	■	■	■	■	■	■	■	■	■	■	■	■	■	■	■	■
PENTLAND HILLS	■	■	■	■	■	■	■	■	■	■	■	■	■	■	■	■	■	■	■	■	■	■	■	■	■





INTRODUCING
***THE NORTH
DISTRICT***

***UCR'S IMPRESSIVE NEW
APARTMENT COMMUNITY***

Imagine a residential community, designed from the ground up to be the ultimate location for living, learning and succeeding in college. That's what students will get with the brand-new North District Apartments, ready to welcome its first class of residents this fall.

Sign up at AmericanCampus.com/NorthDistrict and grab your place in line for one of the first 1,500 spaces available!





UNIVERSITY HOUSING OPERATED BY
 AMERICAN
CAMPUS
COMMUNITIES



North District Apartments is owned and operated by American Campus Communities.

LEASE PROGRAM

SEPT 17, 2021 – JUNE 11, 2022

Year-round living is possible with lease renewal offered near the end of the lease. \$200 Deposit due with signed contract.



1 BEDROOM/1 BATH
512 sq. ft.
Single Room: \$1,475



2 BEDROOM/1 BATH
673 sq. ft.
Single Room: \$1,362



2 BEDROOM/2 BATH
925 sq. ft.
Double Room: \$1,137

WELCOME TO THE NORTH DISTRICT

Amenities will be everywhere you look, from the culinary options at the **Market at North District**; to the free pinball machines and pool tables in the Gaming Lounges; to the various study lounges scattered throughout the twin six-story towers.

Fully furnished rooms? *Check.*
High-speed wireless internet everywhere? *Check.*

24/7 staff? Recreation spaces?
On-site parking? *Check, check and check.*

Little wonder this community is one that you *must* check out.



4 BEDROOM / 2 BATH

1,049 sq. ft.

Single Room: \$1,250

Cost does not include a \$200 Security Deposit or a North District Parking Permit, if applicable. Students can pay in monthly or quarterly installments.

Room costs will be billed Sept.–June through American Campus Communities. If an optional Dining Plan is selected, it will be billed Oct–June through UCR on your UCR student account.

- Available/Included
- Available for a fee
- Some Available
- Partial Fee
- Not Available

Air Conditioning	TV/Recreation Room	Recreation Courts/Fields	24-Hour Assistance	Elevators	Social/Education Progs.	On-Site Parking	Utilities (Gas, Electric, etc.)	Telephone Service	Internet Service	Basic Cable TV Service	Wireless Network
Heating	Secure Laundry	Swimming Pool									
Private Bath	Study Lounge										
Private Kitchen	Fitness Center										
Furnished	Computer Lab										
Refrigerator	Microwave										
Dishwasher	Stove										

FULLY FURNISHED. Floor plans may vary. Single Room = One resident per bedroom; Double Room = Two residents per bedroom. Prices listed are monthly, per resident and are subject to change.

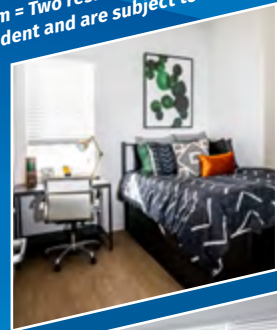
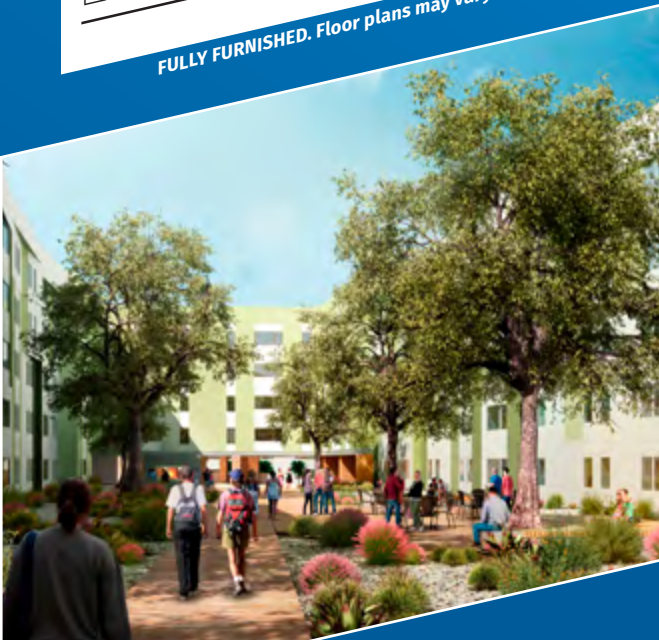

NOTE: North District Apartments owned and operated by American Campus Communities.

A photograph of a modern, curved dining area. The foreground features a curved counter with a glass display case. The background shows a kitchen area with stainless steel equipment and a curved ceiling with recessed lighting. The overall atmosphere is bright and contemporary.

FOOD FOR THOUGHT

***UCR NOW OFFERS DINING PLANS
FOR APARTMENT RESIDENTS, TOO!***



Our restaurants have long featured healthy, high-quality options, with food that's cooked fresh in small batches by real chefs. But space was always at a premium.

With the opening of the two-story **GLASGOW RESIDENTIAL RESTAURANT** (shown here), expanded capacity at **THE BARN** and the new **MARKET AT NORTH DISTRICT**, we can now offer our Dining Plans to all UCR residents for the very first time!

Which means you'll be able to enjoy all-you-care-to-eat meals at six different food stations at both **GLASGOW** and **LOTHIAN**, or fresh entrées at Savor (in the **MARKET AT GLEN MOR**) with just a swipe of your R'Card.

Our "Seeds of Change" initiative has brought delicious, nutritious, sustainable and inclusive dining at every venue we operate.

So next to favorites like pizza and burgers, you'll find healthy vegetarian and vegan fare; spa waters and other alternatives to sugary drinks; salad bars with locally sourced fruits and vegetables, including items grown in UCR's famed citrus groves; and international entrées inspired by cultures across the globe.

With five Dining Plans to choose from (see p. 14), there's never been a better time to dine with us!

FIVE OPTIONAL DINING PLANS

HIGHLANDER UNLIMITED OUR BEST VALUE!

Unlimited meal swipes means you use a Meal Swipe whenever you want, for a full meal or just a healthy snack. It's perfect for those who love flexibility, or someone who enjoys eating multiple small meals a day. The Highlander Unlimited Plan also comes with 60 Dining Dollars per quarter, and four Guest Passes per quarter – great for family and friends!

\$720/month averages less than \$8 for each all-you-care-to-eat meal, not to mention all the in-between snacks and extras you want!

Dining Plans are billed monthly, Oct–June, on your UCR student account.



RESIDENTIAL RESTAURANT
SALAD BAR



THE BARN
MAIN DINING ROOM



STARBUCKS –
MARKET AT GLEN MOR



EMERBEE'S



LOTHIAN RESIDENTIAL RESTAURANT

HIGHLANDER 150 TASTY & THRIFTY

The perfect mix of affordability and practicality. The plan includes 150 delicious meals each quarter — nearly 14 meals a week. Also includes 150 Dining Dollars per quarter, good at every dining location and market on campus. You'll also get six Guest Passes per quarter. **\$630/month**

RESIDENTIAL HALF & HALF

A smaller meal plan for those who like to cook AND like to eat out. The plan allows 50 Meal Swipes per quarter, plus 210 Dining Dollars per quarter to spend at any campus venue or market. Not available to students in the Residence Halls. **\$270/month**

THE MARKET BEST FOR COOKS

If you enjoy cooking in your own apartment, the Market Plan provides \$300 in Dining Dollars per quarter and no Meal Swipes. Not available to students in the Residence Halls. **\$100/month**

For more information about any of our Dining Plans or restaurants, please visit dining.ucr.edu



ENTRANCE TO THE BARN



DINING DOLLARS ONLY PAY AS YOU GO!

DON'T WANT TO BE TIED INTO A MONTHLY PLAN? NO PROBLEM!

You can buy Dining Dollars as you need them, and at a discount too! Purchase **55 DINING DOLLARS FOR JUST \$50** (a 10% discount); or purchase **115 DINING DOLLARS FOR \$100 EVEN** (that's 15% off!).

FYI: Dining Dollars are accepted at every restaurant and market at UCR, including Starbucks at the Market at Glen Mor.

BANNOCKBURN VILLAGE



- Available/Included
- Available for a fee
- Some Available
- Partial Fee
- Not Available

Air Conditioning	Heating	Private Bath	Private Kitchen	Furnished	Refrigerator	Dishwasher	Microwave	Stove	TV/Recreation Room	Secure Laundry	Study Lounge	Fitness Center	Computer Lab	Swimming Pool	Recreation Courts/Fields	24-Hour Assistance	Elevators	Social/Education Progs.	On-Site Parking	Utilities (Gas, Electric, etc.)	Telephone Service	Internet Service	Basic Cable TV Service	Wireless Network
<input checked="" type="checkbox"/>	<input checked="" type="checkbox"/>	<input checked="" type="checkbox"/>	<input checked="" type="checkbox"/>	<input type="checkbox"/>	<input type="checkbox"/>	<input type="checkbox"/>	<input type="checkbox"/>	<input type="checkbox"/>	<input type="checkbox"/>	<input checked="" type="checkbox"/>	<input checked="" type="checkbox"/>	<input type="checkbox"/>	<input checked="" type="checkbox"/>	<input checked="" type="checkbox"/>	<input type="checkbox"/>	<input checked="" type="checkbox"/>	<input type="checkbox"/>	<input checked="" type="checkbox"/>	<input type="checkbox"/>	<input checked="" type="checkbox"/>	<input type="checkbox"/>	<input type="checkbox"/>	<input type="checkbox"/>	<input type="checkbox"/>

Some units furnished. Floor plans may vary.

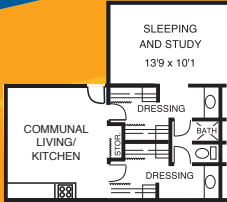

BANNOCKBURN SUITE
Shared Bath/Shared Kitchen/Furnished
295 sq. ft.
Single Room: \$750



1 BEDROOM/1 BATH
500 sq. ft.
Single Room: \$1,170
Double Room: \$585



SCOTS SUITE
Shared Bath/No Kitchen/
Furnished
250 sq. ft.
Single Room: \$680

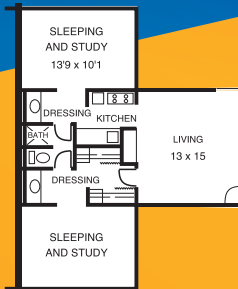

2 BEDROOM/1 BATH
680 sq. ft.
Single Room: \$750
Double Room: \$375

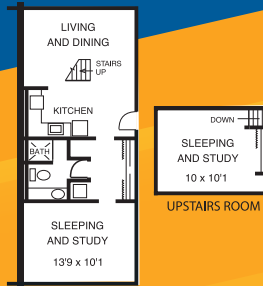

LOFT APARTMENT
620 sq. ft.
Apartment: \$1,310
Per Room: \$655

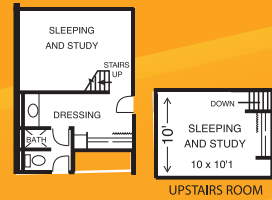

LOFT SUITE
Shared Bath / No Kitchen /
Furnished
370 sq. ft.
Single Room: \$720

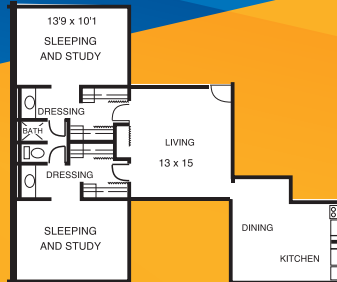

2 BEDROOM DELUXE/1 BATH
840 sq. ft.
Single Room: \$790
Double Room: \$395



LEASE PROGRAM

SEPT. 17, 2021 – JUNE 30, 2022

Year-round living is possible with lease renewal offered near the end of the lease.
\$200 Deposit due with signed contract.

You're sure to love one of the many high-value floor plans available at the alpine-styled Bannockburn Village, which features everything from one-room kitchenless suites, to traditional one- and two-bedroom apartments.

Single Room = One resident per bedroom; Double Room = Two residents per bedroom.
Prices listed are monthly, per resident and are subject to change.



1 BEDROOM/1 BATH
 630 sq. ft.
 Single Room: \$1,320
 Double Room: \$660



2 BEDROOM/1 BATH
 815 sq. ft.
 Single Room: \$880
 Double Room: \$440

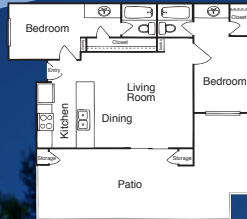

2 BEDROOM/2 BATH
 850 sq. ft.
 Single Room: \$920
 Double Room: \$460



2 BEDROOM DELUXE/2 BATH
 870 sq. ft.
 Single Room: \$950
 Double Room: \$475



FALKIRK

Falkirk offers students traditional, spacious apartment living in a lushly landscaped setting that exudes warmth and charm.





FULLY FURNISHED.
Floor plans may
vary. Prices subject
to change.

GLEN MOR

*Designed as a bridge between the Residence Halls and apartment-style independence, Glen Mor is the number one choice for UCR's second-year students. It's also home to the **STRIDE 2 SUCCESS Living-Learning Community**, designed for second years. With its fully furnished, single-occupancy rooms, Glen Mor is everything you'd want in an on-campus apartment. And a whole lot Mor.*



Unfurnished. Floor plans may vary. Single Room = One resident per bedroom; Double Room = Two residents per bedroom. Prices listed are monthly, per resident and are subject to change.

Legend	Air Conditioning	Heating	Private Bath	Private Kitchen	Furnished	Refrigerator	Dishwasher	Microwave	Stove	TV/Recreation Room	Secure Laundry	Study Lounge	Fitness Center	Computer Lab	Swimming Pool	Recreation Courts/Fields	24-Hour Assistance	Elevators	Social/Education Progs.	On-Site Parking	Utilities (Gas, Electric, etc.)	Telephone Service	Internet Service	Basic Cable TV Service	Wireless Network
■ Available/Included	■	■	■	■	□	■	■	□	■	■	■	■	□	■	■	□	■	□	■	■	■	■	■	□	□
■ Available for a fee																				■	■	■	■	■	■
■ Some Available																									
○ Partial Fee																					○				
□ Not Available																									



THE PLAZA

LEASE PROGRAM

SEPTEMBER 17, 2021 – JUNE 30, 2022

Year-round living is possible with lease renewal offered near the end of the lease. \$200 Deposit due with signed contract.

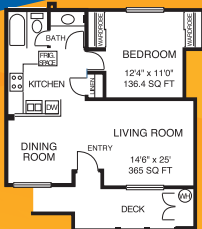

1 BEDROOM/1 BATH

582 sq. ft.

Single Room: \$1,260

Double Room: \$630



2 BEDROOM/1.25 BATH

671 sq. ft.

Single Room: \$820

Double Room: \$410



2 BEDROOM/ 2 BATH

854 sq. ft.

Single Room: \$900

Double Room: \$450



The Plaza boasts a faux “Palm Springs” aesthetic – complete with its resort-like pool – and offers large, traditional one- and two-bedroom apartments.

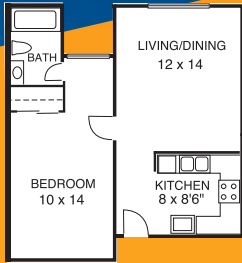

1 BEDROOM/1 BATH
530 sq. ft.
Single Room: \$1,346
Double Room: \$673

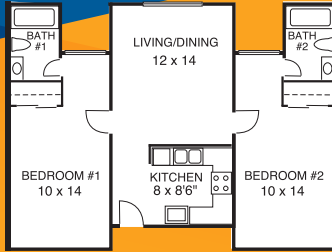

2 BEDROOM/2 BATH
780 sq. ft.
Single Room: \$1,346
Double Room: \$673



LEASE PROGRAM

SEPTEMBER 17, 2021 – JUNE 30, 2022

Year-round living is possible with lease renewal offered near the end of the lease. \$200 Deposit due with signed contract.



Legend:																									
<input checked="" type="checkbox"/> Available/Included	Air Conditioning	Heating	Private Bath	Private Kitchen	Furnished	Refrigerator	Dishwasher	Microwave	Stove	TV/Recreation Room	Secure Laundry	Study Lounge	Fitness Center	Computer Lab	Swimming Pool	Recreation Courts/Fields	24-Hour Assistance	Elevators	Social/Education Progs.	On-Site Parking	Utilities (Gas, Electric, etc.)	Telephone Service	Internet Service	Basic Cable TV Service	Wireless Network
<input checked="" type="checkbox"/> Available for a fee	<input checked="" type="checkbox"/>	<input checked="" type="checkbox"/>	<input checked="" type="checkbox"/>	<input checked="" type="checkbox"/>	<input checked="" type="checkbox"/>	<input checked="" type="checkbox"/>	<input checked="" type="checkbox"/>	<input checked="" type="checkbox"/>	<input checked="" type="checkbox"/>	<input checked="" type="checkbox"/>	<input checked="" type="checkbox"/>	<input checked="" type="checkbox"/>	<input checked="" type="checkbox"/>	<input checked="" type="checkbox"/>	<input checked="" type="checkbox"/>	<input checked="" type="checkbox"/>	<input checked="" type="checkbox"/>	<input checked="" type="checkbox"/>	<input checked="" type="checkbox"/>	<input checked="" type="checkbox"/>	<input checked="" type="checkbox"/>	<input checked="" type="checkbox"/>	<input checked="" type="checkbox"/>	<input checked="" type="checkbox"/>	<input checked="" type="checkbox"/>
<input type="checkbox"/> Some Available	<input type="checkbox"/>	<input type="checkbox"/>	<input type="checkbox"/>	<input type="checkbox"/>	<input type="checkbox"/>	<input type="checkbox"/>	<input type="checkbox"/>	<input type="checkbox"/>	<input type="checkbox"/>	<input type="checkbox"/>	<input type="checkbox"/>	<input type="checkbox"/>	<input type="checkbox"/>	<input type="checkbox"/>	<input type="checkbox"/>	<input type="checkbox"/>	<input type="checkbox"/>	<input type="checkbox"/>	<input type="checkbox"/>	<input type="checkbox"/>	<input type="checkbox"/>	<input type="checkbox"/>	<input type="checkbox"/>	<input type="checkbox"/>	<input type="checkbox"/>
<input type="checkbox"/> Partial Fee	<input type="checkbox"/>	<input type="checkbox"/>	<input type="checkbox"/>	<input type="checkbox"/>	<input type="checkbox"/>	<input type="checkbox"/>	<input type="checkbox"/>	<input type="checkbox"/>	<input type="checkbox"/>	<input type="checkbox"/>	<input type="checkbox"/>	<input type="checkbox"/>	<input type="checkbox"/>	<input type="checkbox"/>	<input type="checkbox"/>	<input type="checkbox"/>	<input type="checkbox"/>	<input type="checkbox"/>	<input type="checkbox"/>	<input type="checkbox"/>	<input type="checkbox"/>	<input type="checkbox"/>	<input type="checkbox"/>	<input type="checkbox"/>	<input type="checkbox"/>
<input type="checkbox"/> Not Available	<input type="checkbox"/>	<input type="checkbox"/>	<input type="checkbox"/>	<input type="checkbox"/>	<input type="checkbox"/>	<input type="checkbox"/>	<input type="checkbox"/>	<input type="checkbox"/>	<input type="checkbox"/>	<input type="checkbox"/>	<input type="checkbox"/>	<input type="checkbox"/>	<input type="checkbox"/>	<input type="checkbox"/>	<input type="checkbox"/>	<input type="checkbox"/>	<input type="checkbox"/>	<input type="checkbox"/>	<input type="checkbox"/>	<input type="checkbox"/>	<input type="checkbox"/>	<input type="checkbox"/>	<input type="checkbox"/>	<input type="checkbox"/>	<input type="checkbox"/>

FULLY FURNISHED. Floor plans may vary. Single Room = One resident per bedroom; Double Room = Two residents per bedroom. Prices listed are monthly, per resident and are subject to change. Stonehaven is owned and operated by EAH.

All inclusive. Fully furnished. Residents enjoy a variety of amenities unique among the on-campus apartment communities. Stonehaven is a gated community with on-site surveillance.



STONEHAVEN

DUNDEE RESIDENCE HALL



DUNDEE

AND THE RESIDENCE HALLS



For many students, living in a Residence Hall is the ultimate college experience: a lively space where rooms, meals and lives are shared, a home where residents often get their first taste of adulthood.

In fact, you're never more than a few steps away from classes, restaurants, shops, libraries or the Rec Center.

If you missed your chance to live in one of our four Residence Halls — or just want the chance to do it all again — we're opening up a limited number of rooms to returning students.

Our newest community, **DUNDEE**, will house returning students in its upper floors (which seems only appropriate for upperclassmen and women).

Adjacent to Dundee is the dazzling **GLASGOW RESIDENTIAL RESTAURANT**, a signature architectural landmark featuring two levels filled with multiple culinary options. Sure, Glasgow's open to the whole campus, but live at Dundee, and it's right in your own backyard!

PENTLAND HILLS LOUNGE

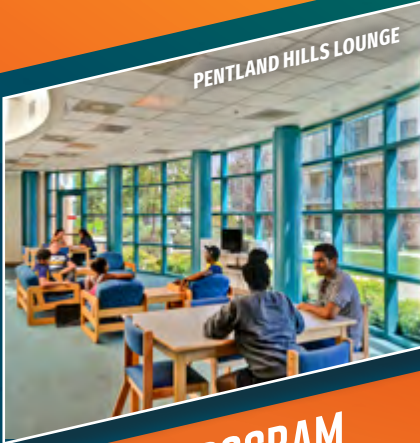

TYPICAL DOUBLE-OCCUPANCY ROOM



RESIDENTIAL MONTHLY HOUSING COSTS

SINGLE-OCCUPANCY ROOM*	\$1,550
DOUBLE-OCCUPANCY ROOM	\$1,350
TRIPLE-OCCUPANCY ROOM	\$1,150

RESIDENTIAL MONTHLY DINING PLAN COSTS

HIGHLANDER 150	\$630
HIGHLANDER UNLIMITED	\$720

LEASE PROGRAM

SEPTEMBER 18/19, 2021-JUNE 11, 2022

Non-refundable fees (\$270 Contract Fee and \$63 Activity Fee) due with signed contract. All Residence Halls feature Single-*, Double- & Triple-Occupancy Rooms. Prices subject to change. A Dining Plan is required for all Residence Hall residents. See page 14 for Dining Plan descriptions.

*Single rooms not available at Pentland Hills.

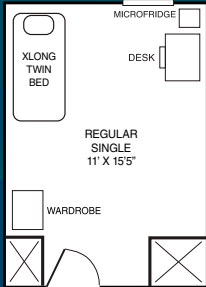

DUNDEE SINGLE

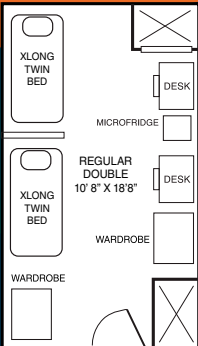

DUNDEE DOUBLE

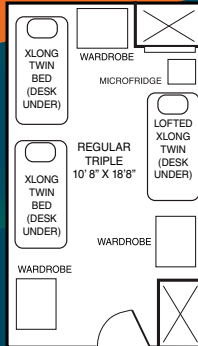

DUNDEE TRIPLE

DUNDEE TRIPLE-OCCUPANCY ROOM



ALL RESIDENCE HALL ROOMS ARE FULLY FURNISHED. Room layouts may vary. Students can pay in monthly or quarterly installments.

Dundee is owned by American Campus Communities (ACC) and operated cooperatively by ACC and UCR Housing.



NON-PROFIT ORG.
U.S. POSTAGE
PAID
UCR

UC RIVERSIDE
Housing Services

Housing Services Office
900 University Avenue
Riverside, CA 92521

IS YOUR STUDENT READY TO MAKE A BIG MOVE? CHECK OUT OUR OPTIONS FOR FALL!

SEE PAGE 2 FOR
FULL DETAILS OR GO
ONLINE AT
HOUSING.UCR.EDU

